

- 01 WALL BOW
- 02 EROSION
- 03 EROSION
- 04 WALL BOW
- 05 WALL BOW
- 06 EROSION
- 07 WALL BOW
- 08 WALL BOW
- 09 EROSION

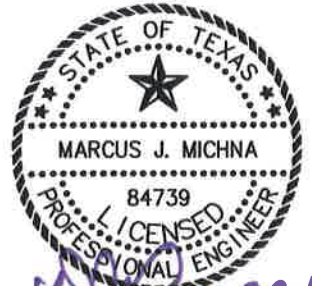

SITE INSPECTIONS WERE LIMITED TO VISUAL OBSERVATIONS ON JANUARY 29TH, 2015 AND REPRESENTS THE CURRENT CONDITIONS BASED ON OUR PROFESSIONAL OPINION.

2016 BULKHEAD REPAIRS PROJECT
 FLAMINGO ISLES MUD
 HITCHCOCK, TEXAS

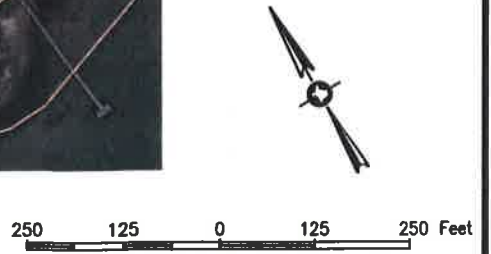

DATE:	02/05/16
SCALE:	1:250
DWG:	EX 1.00
JOB NO:	16-103
REV:	A



1 WALL BOW



2 EROSION



4 WALL BOW



5 WALL BOW



7 WALL BOW



8 WALL BOW



9 EROSION

SITE INSPECTIONS WERE LIMITED TO VISUAL OBSERVATIONS ON JANUARY 29TH, 2015 AND REPRESENTS THE CURRENT CONDITIONS BASED ON OUR PROFESSIONAL OPINION.

2016 BULKHEAD REPAIRS PROJECT
FLAMINGO ISLES MUD
HITCHCOCK, TEXAS



DATE:	02/05/16
SCALE:	NTS
DWG:	EX 1.02
JOB NO:	16-103
REV:	A

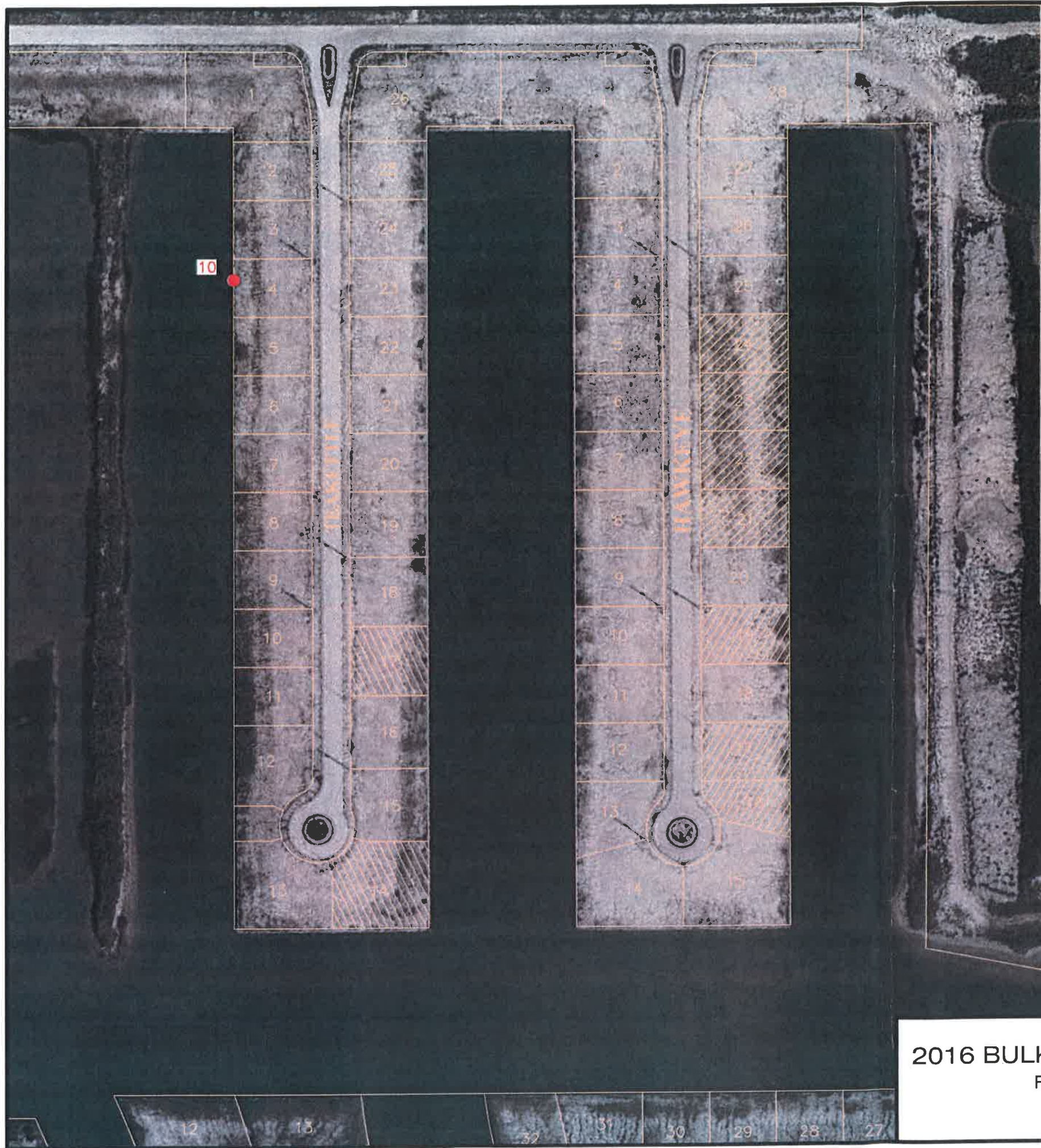

10 WALL BOW

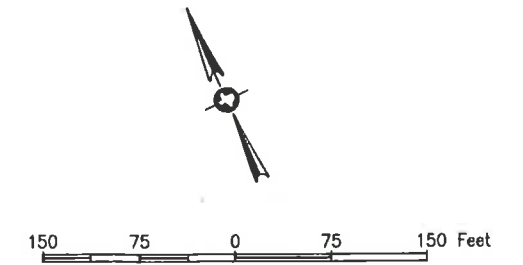

2016 BULKHEAD REPAIRS PROJECT
 FLAMINGO ISLES MUD
 HITCHCOCK, TEXAS

SHELMARK
 ENGINEERING, L.L.C.
CIVIL | MARINE | PLANNING | STRUCTURAL
 921 FM 517 Road East | Dickinson, Texas 77539
TX Firm No. F-2115 TEXAS REGISTERED ENGINEERING FIRM F-2115

DATE:	02/05/16
SCALE:	1:150
DWG:	EX 1.03
JOB NO:	16-103
REV:	A